

MC3090-G Quick Start Guide

<http://www.symbol.com/mc3000>
See User Guide for more information

POST IN WORK AREA

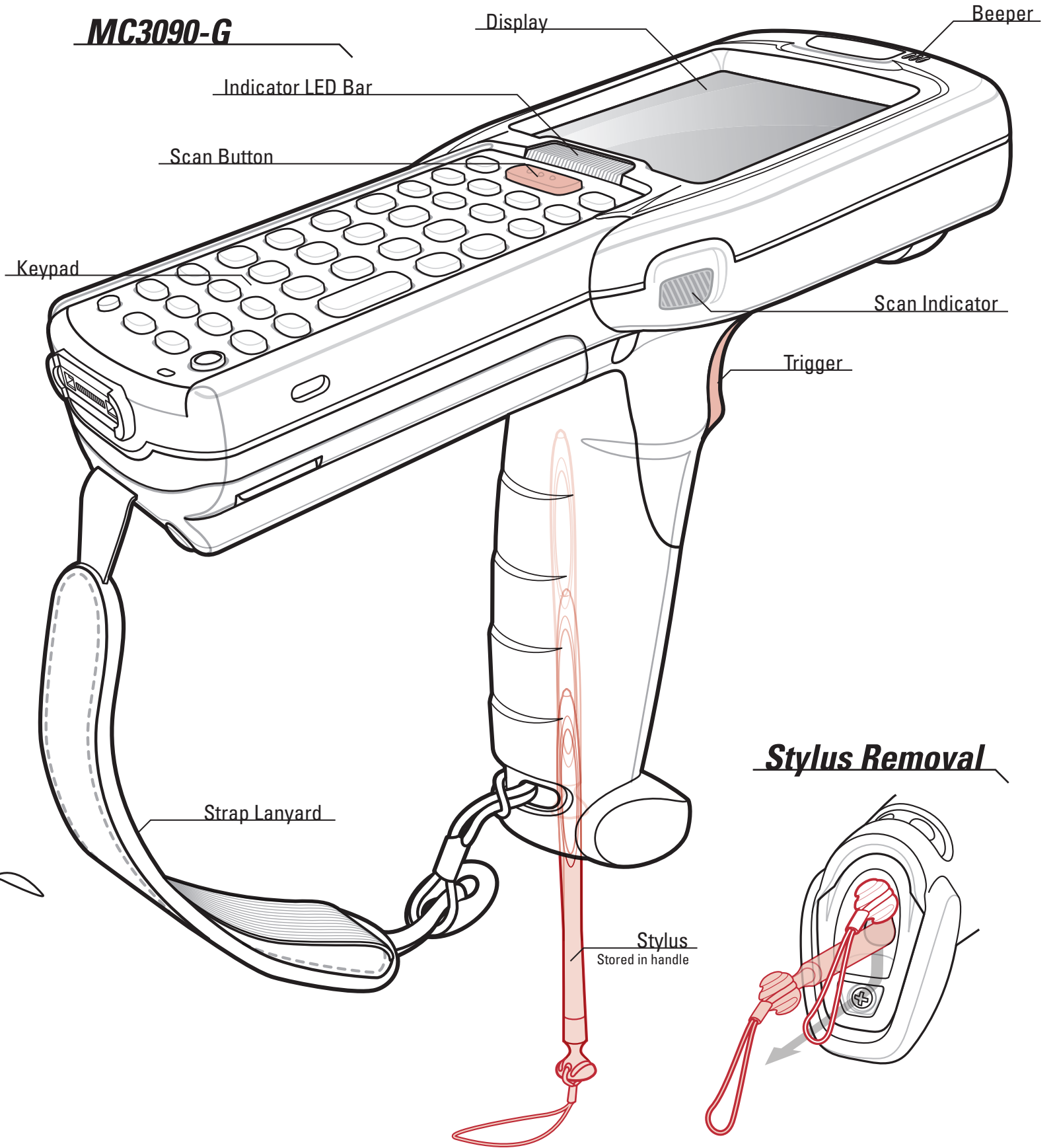

Battery Removal

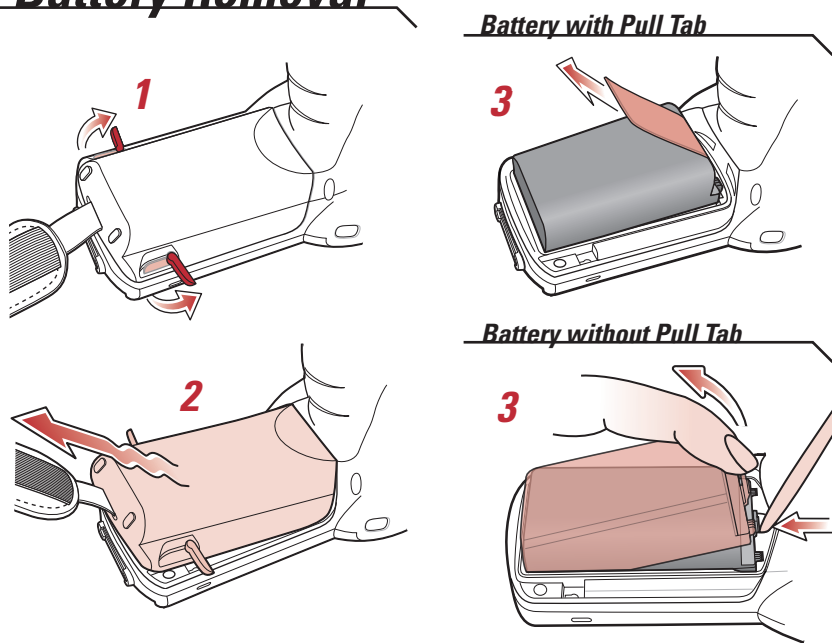

Stylus Removal

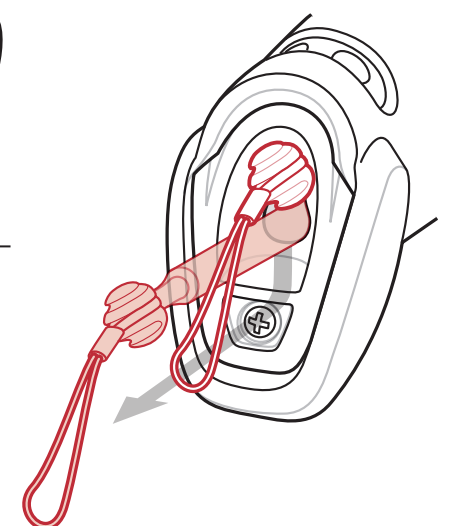

Accessory Installation

Comm/Charge Cables

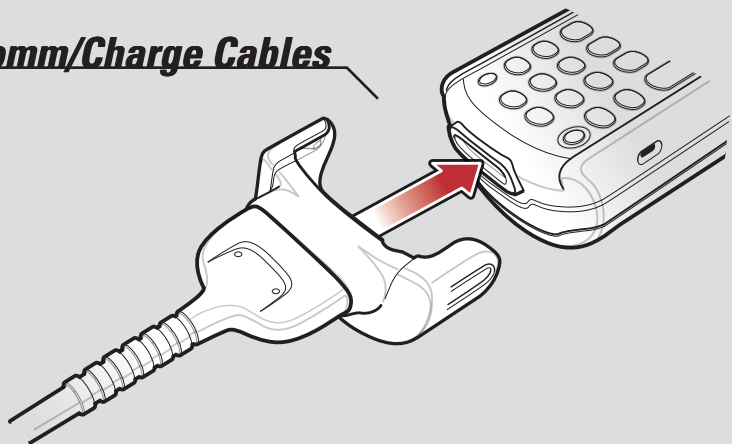

Rubber Boot

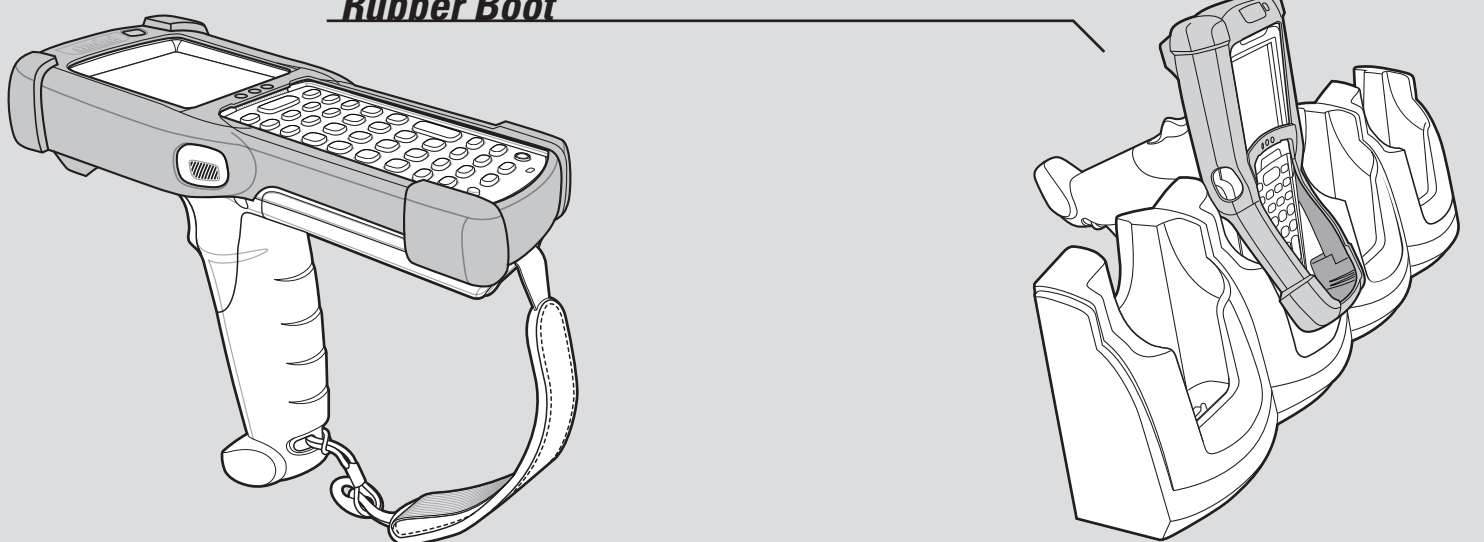

Charging Instructions

● = LED Indicator Location
Slow Flash = Normal Charge | Solid Amber = Full Charge | Fast Flash = Charging Error

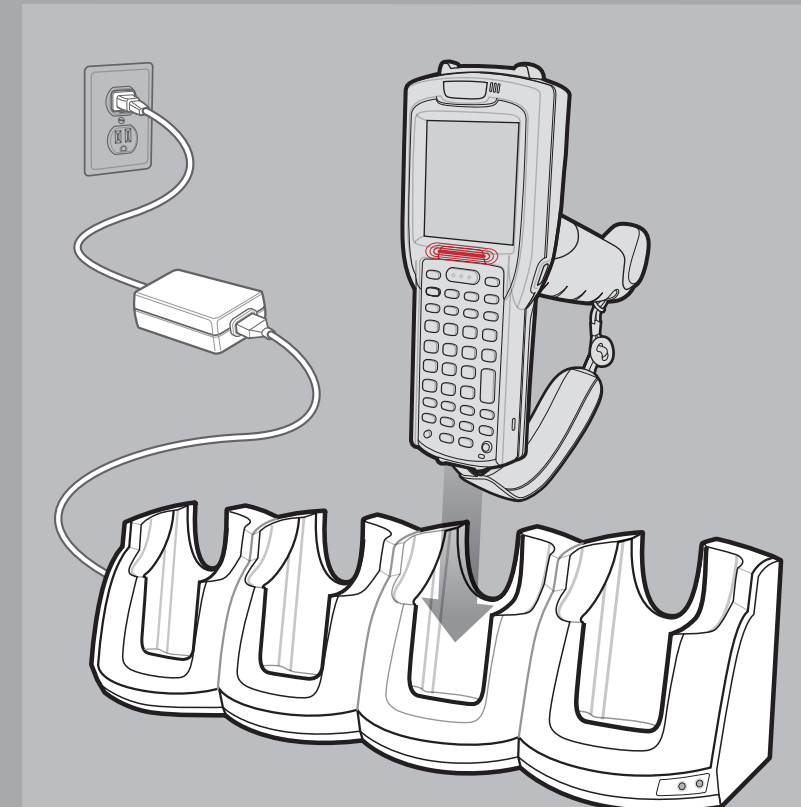
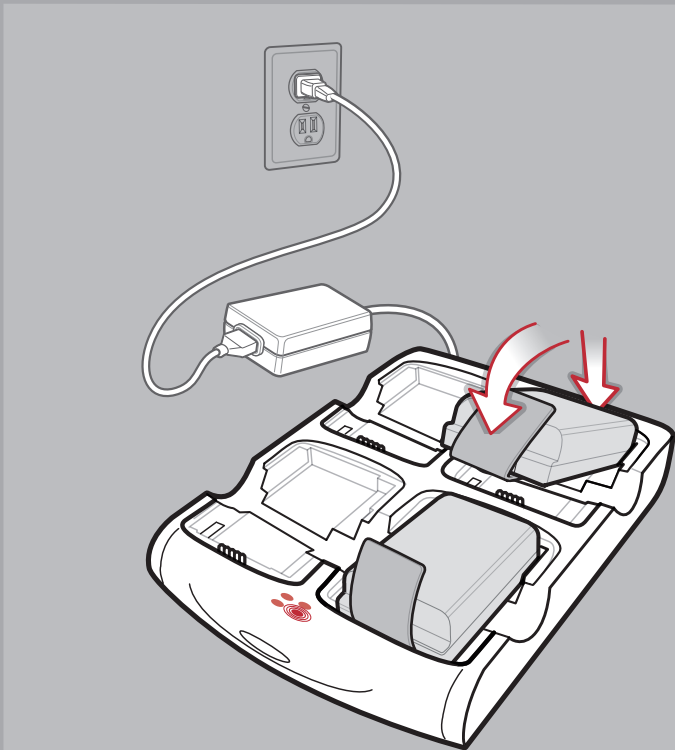

Four Slot Spare Battery Charger

Single Slot Serial Cradle

Four Slot Cradles

Charge-Only Cradle and Ethernet Cradle

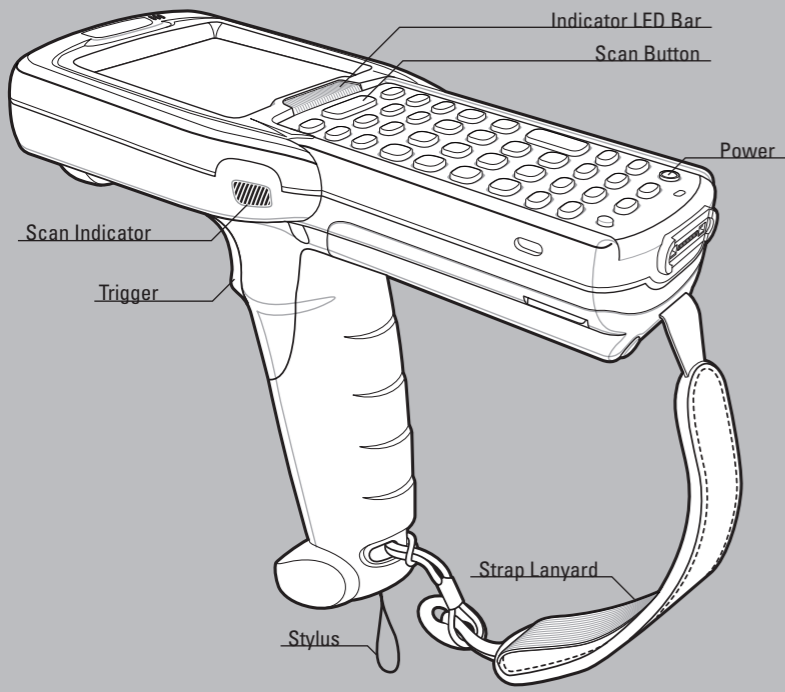

Optimum Scanning Positions



Optimum Upright Body Posture



Avoid Extreme Wrist Angles

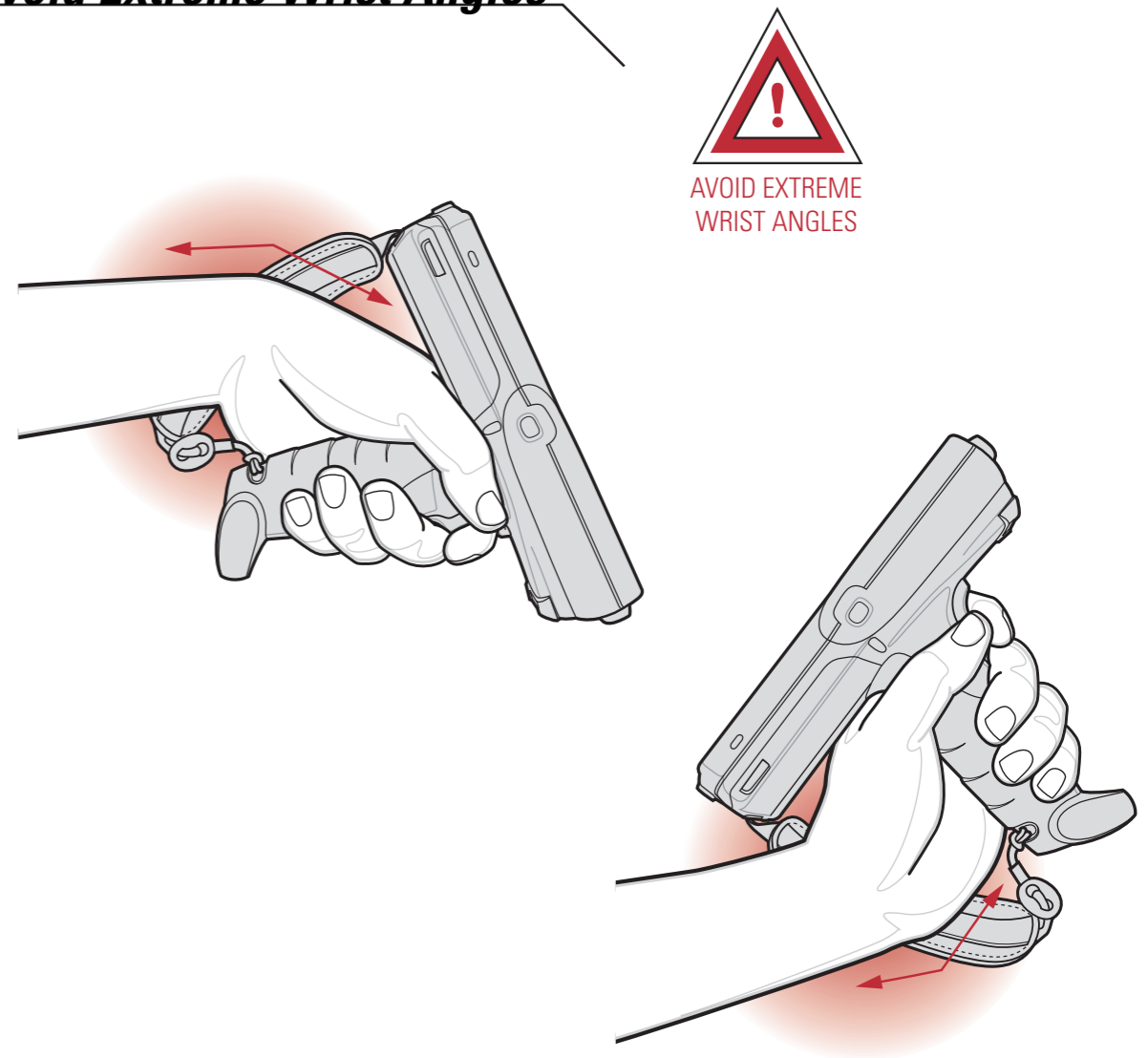

Optimum Body Posture for Low Scanning

ALTERNATE LEFT AND RIGHT KNEES

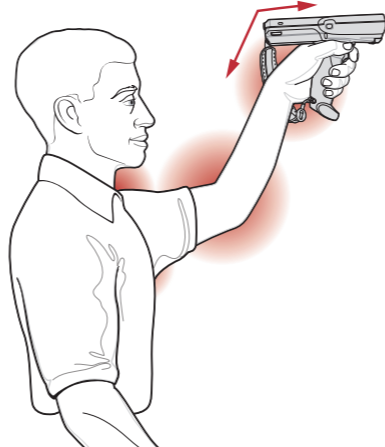

Optimum Body Posture for High Scanning

USE A LADDER



72-71347-01 Rev A August 2005